

Tengzhou Freed Rotary Joint Ltd.

Type HK Rotary Joint Usage & Maintenance Handbook

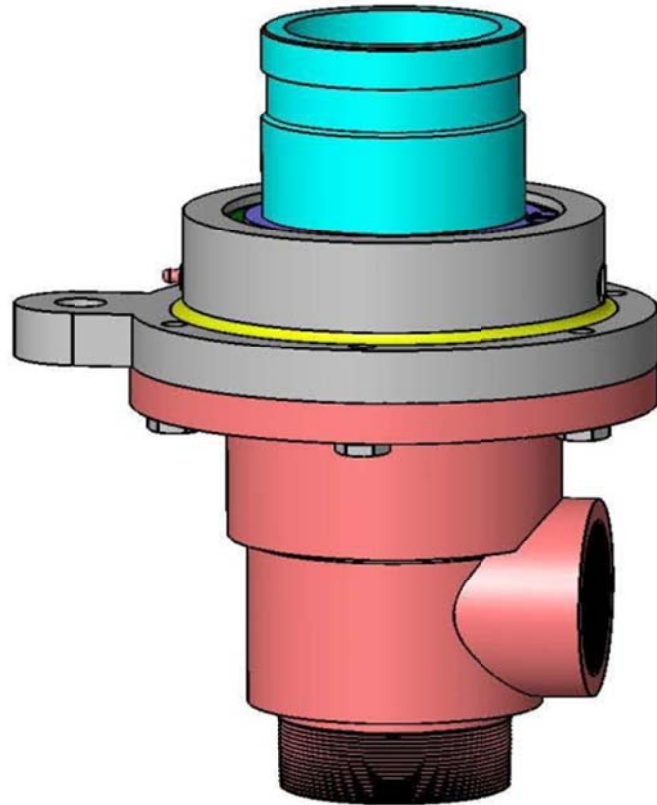

Three-dimensional Drawing of type HK Rotary Joint



Practicality of type HK Rotary Joint

Freed Rotary Joint Handbook, Handbook No.: FRD029EH, Revision: 2013B, Released Date: 2013-07-07, ©Copyright 2013.

INSTALLATION INSTRUCTIONS FOR TYPE HK ROTARY JOINTS

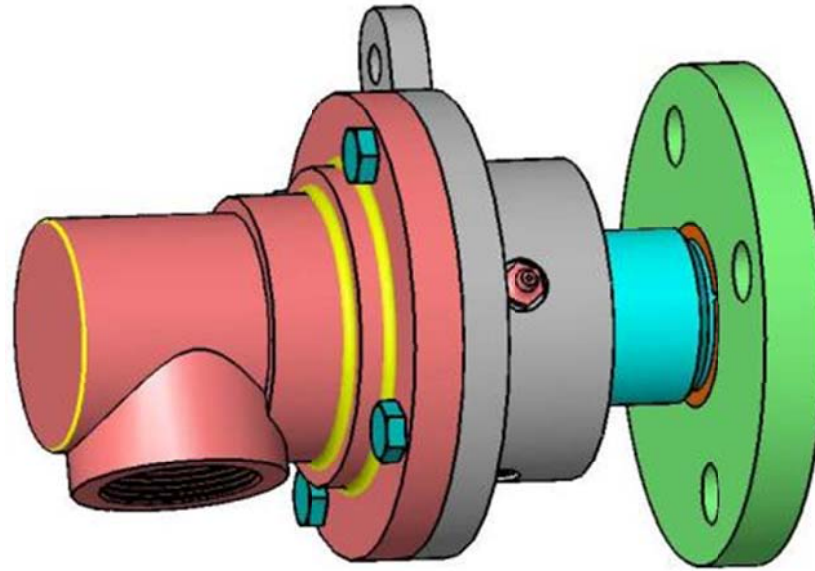

Figure 1 Assembly drawing for Single flow type HK rotary joint with quick release flange

NOTE: Please follow your company's safety procedures whenever working on type HK rotary joint and read all of the installation instructions completely before proceeding.

Single Flow type HK rotary joint with quick release flange

1. the work before installing rotary joint

Before installing rotary joint, please remove all scale and other dirt from the pipe and cylinder. The dirty media can reduce the service life of rotary joint.

2. installation of quick release nipple

Place quick release flange (1) and split wedge on the nipple, place the nipple into the pilot of journal flange, tighten bolts evenly on quick release flange so that the space between quick release flange (1) and journal flange is even.

3. Flexible Hose Connection

Given your rotary joint application, choose metal hose, with ratings able to sustain the flow media. When connecting the rotary joint to the fixed pipe, the flexible hose (2) should be installed as close to the rotary joint as possible, in a relaxed connection, neither stretched nor compressed. If you have an unusually long run of hose, it is strongly recommended for you to support the hose so as not to overload the bearings of the rotary joint.

The correct installation of metal hose see figure 2.

Flexible Hose Connection

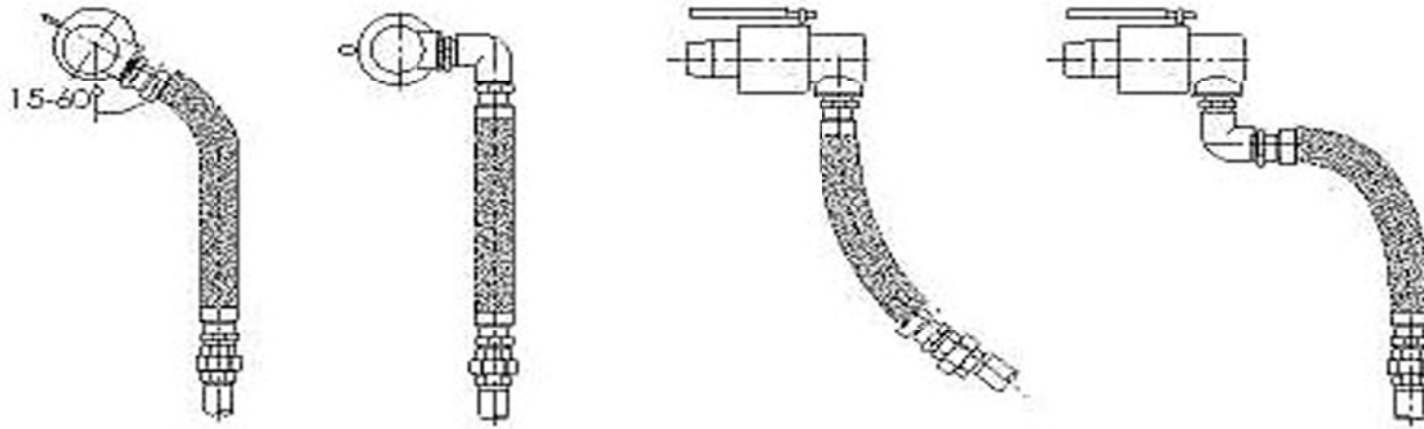

Figure 2 the correct installation of metal hose

The wrong installation of metal hose see figure 3.

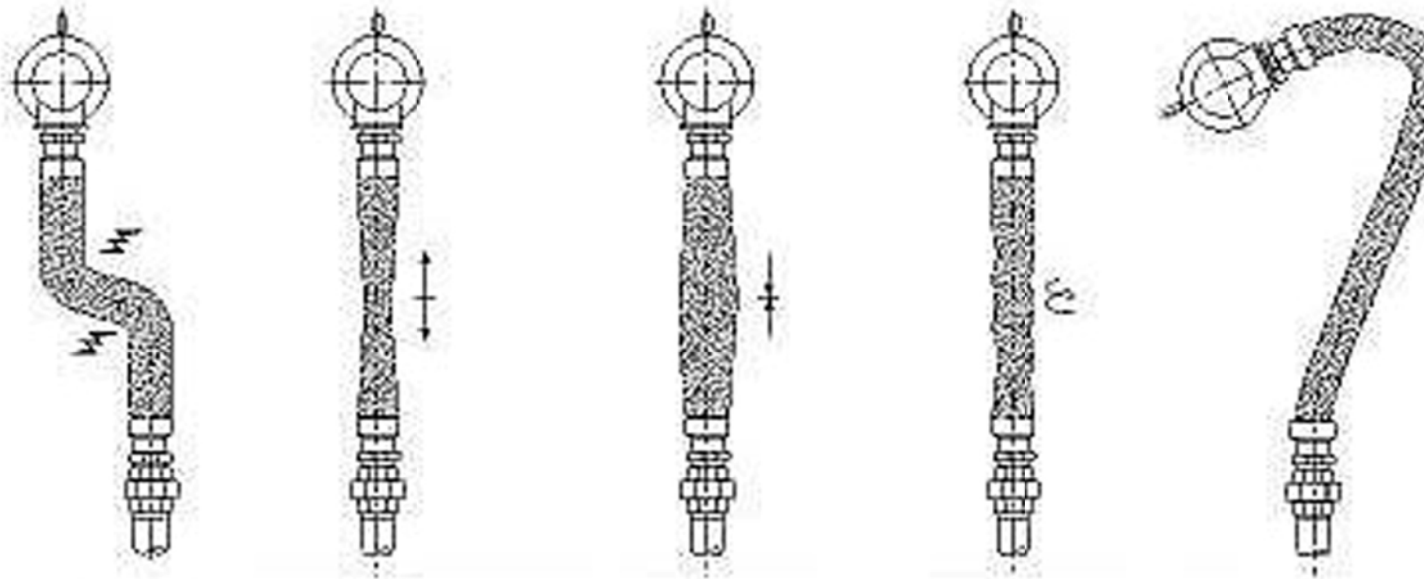

Figure 3 the wrong installation of metal hose

4. Maintenance

There are two ball bearings in the body of rotary joint to support. During running rotary joint, it need lubricate the bearings in the body of rotary joint with grease on time.

5. Stock

Type HK rotary joint should be placed in a drying air circulation place, avoiding in a wet place.

6. Safety

Rotary joint should be fastened with equipment after installation strongly, forbid to loose during running.

During transportation and installation of rotary joint, take care to carry.

Surface contour drawing for Single flow type HK rotary joint with quick release nipple see Figure 4.

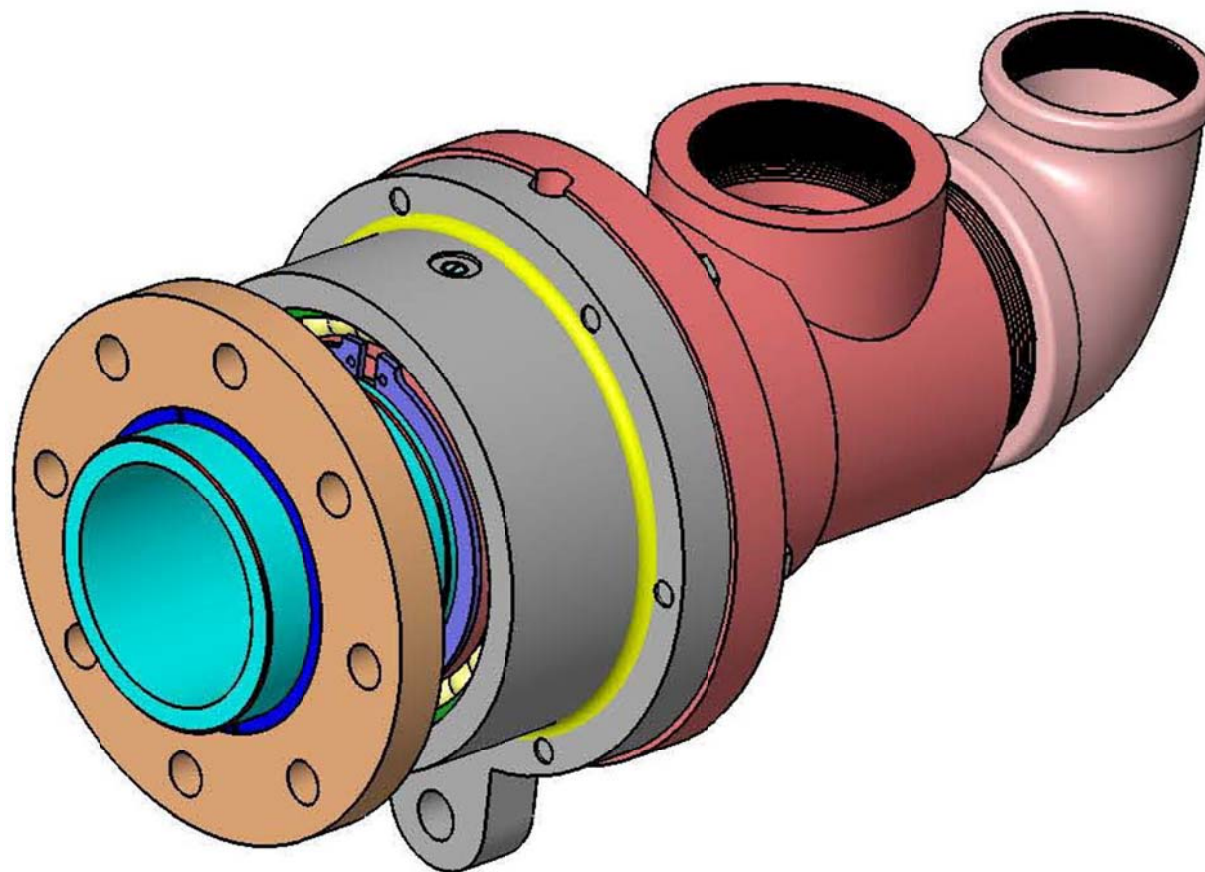

Figure 4 Surface Contour drawing for Dual flow type HK rotary joint with quick release nipple

Contact us

Tengzhou Freed Rotary Joint Ltd.

Address: Qianxin street, Tengzhou city, Shandong province, China.

Tel: 0632-5508518, 5508528

Fax: 0632-5502020

E-mail: freedseal@188.com

Web site: www.freedseal.com

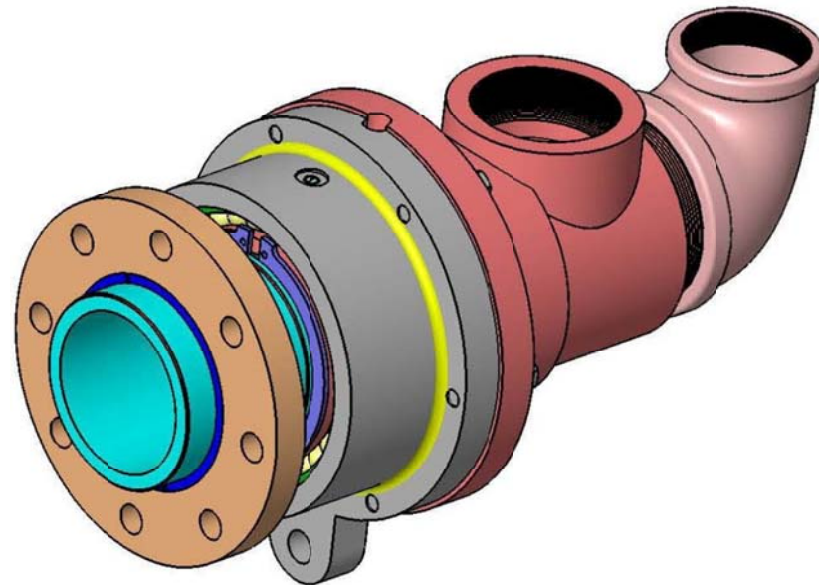

Three-dimensional Drawing of type HK Rotary Joint